

# "U.S. PUBLIC LAND SURVEY MONUMENT RECORD" OZAUKEE COUNTY, WISCONSIN

TYPE OF MONUMENT: Plastic Berntsen monument w/brass cap

STATE PLANE COORDINATES: N: 499974.23

E: 2551647.10

ELEVATION: 792.96 M.S.L. DATUM: 1929

FIELD BOOK: 2 PAGE: 68

FIELDWORK BY: Tom Genske and Kapur & Associates 1995

RECORD DRAWN BY: MARK BANTON

CONTROL ACCURACY:

HORIZONTAL: 3RD ORDER, CLASS 1 VERTICAL: 3RD ORDER

CORNER INDEX No. 432

SECTION 6

TOWNSHIP 10

RANGE 22

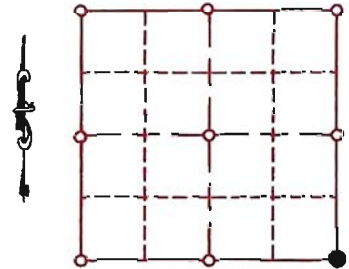

LOCATION

### BASIS OF MONUMENT LOCATION

1967- Clarence Piepenburg S-139 found a brass plug set in concrete 4" under pavement

1995- Tom Genske (County Surveyor) found a PK nail in Pavement, found a 2-1/2" diameter plug attached to a 1/2" rod set in concrete (poor condition), replaced with a plastic Berntsen monument with 2" riser and brass cap

SEAL:



DATA SHOWN HEREON  
IS CERTIFIED AS CORRECT:

*Mark Banton*  
Ozaukee County Surveyor

DATE: 1/24/08

### TIE SKETCH

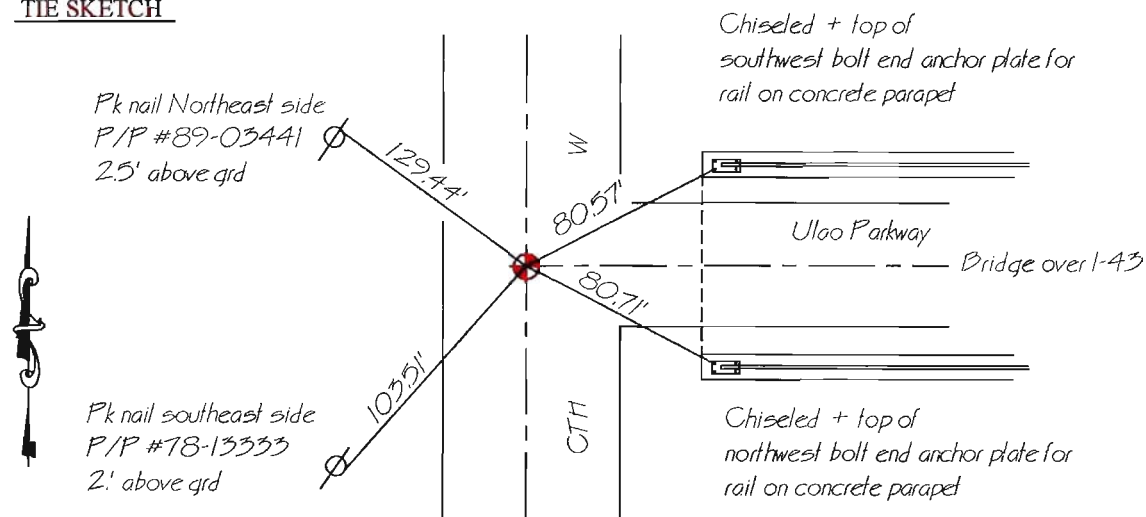

### MAINTENANCE RECORD

#### MONUMENT LEGEND

- = BERNTSEN MONUMENT (SEE TYPE OF MON. ABOVE)
- = CONCRETE MONUMENT W/ BRASS CAP
- = CONCRETE MONUMENT W/ CROSS
- = 5/8" REBAR WITH ALUMINUM CAP

DATE	BY WHOM	REMARKS
1-24-08	M. BANTON	RE-NUMBER TO MATCH NEW SYSTEM