

"U.S. PUBLIC LAND SURVEY MONUMENT RECORD"
OZAUKEE COUNTY, WISCONSIN

TYPE OF MONUMENT: Bernsten Monument w/ brass cap

STATE PLANE COORDINATES: N: 570118.44

E: 2585046.81

ELEVATION: 588.96 M.S.L. DATUM: 1929

FIELD BOOK: K&A folder PAGE: 866

FIELDWORK BY: KAPUR AND ASSOCIATES

RECORD DRAWN BY: MARK BANTON

CONTROL ACCURACY:

HORIZONTAL: 3RD ORDER, CLASS 1 VERTICAL: 3RD ORDER

CORNER INDEX No. 1064-4

SECTION 6

TOWNSHIP 12

RANGE 23

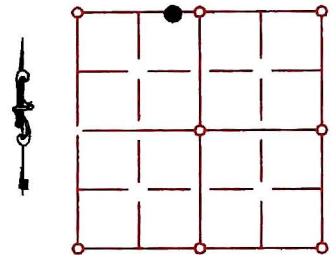

LOCATION

SEAL:

BASIS OF MONUMENT LOCATION

Kapur and Associates set monument at location of Railroad Spike from previous surveys. - 1999



DATA SHOWN HEREON IS CERTIFIED AS CORRECT:

Mark Banton

Ozaukee County Surveyor

DATE: 16 May 2003 *1 Feb 07*

TIE SKETCH

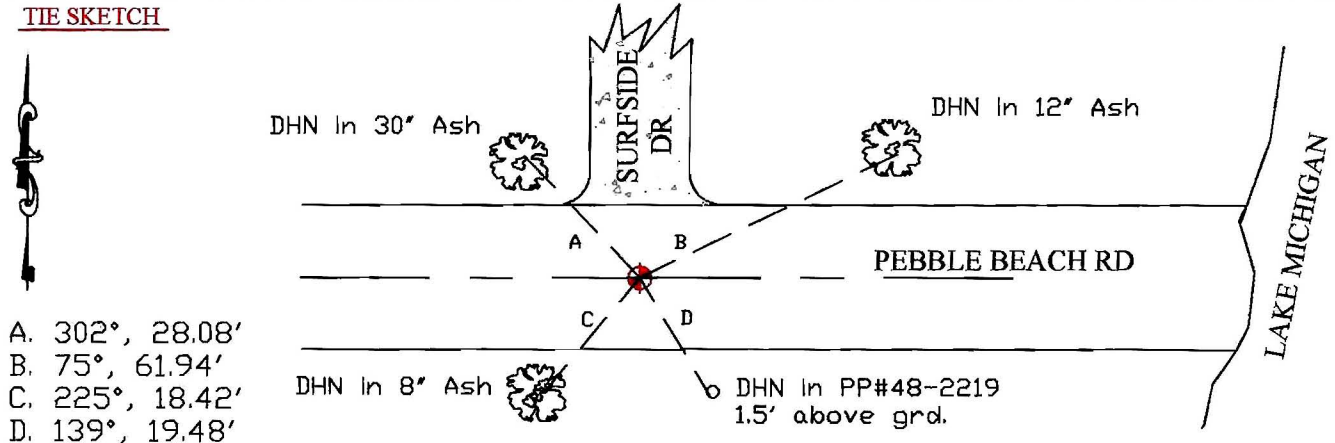

MAINTENANCE RECORD

- MONUMENT LEGEND**
- = BERNTSEN MONUMENT (SEE TYPE OF MON. ABOVE)
 - = CONCRETE MONUMENT w/ BRASS CAP
 - = CONCRETE MONUMENT w/ CROSS
 - = 5/8" REBAR WITH ALUMINUM CAP

DATE	BY WHOM	REMARKS
1 FEB 2007	M. BANTON	RE-NUMBER CORNER