

"U.S. PUBLIC LAND SURVEY MONUMENT RECORD"
OZAUKEE COUNTY, WISCONSIN

TYPE OF MONUMENT: 3/4" X 15' ALUMINUM ROD
 STATE PLANE COORDINATES: N: 513221.62
 E: 2531489.00
 ELEVATION: 868.84 M.S.L. DATUM: 1929
 THETA ANGLE: _____
 FIELD BOOK: 3 PAGE: 36
 FIELDWORK BY: 1996 - Tom Genske and Kapur and Associates
 RECORD DRAWN BY: MARK BANTON
 CONTROL ACCURACY:
 HORIZONTAL: 3RD ORDER, CLASS 1 VERTICAL: 3RD ORDER

CORNER INDEX No. 547-1
 SECTION 29
 TOWNSHIP 11
 RANGE 21

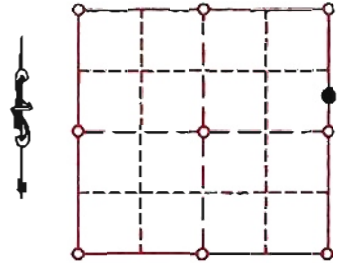

LOCATION

BASIS OF MONUMENT LOCATION

1996 - Tom Genske, Ozaukee County Surveyor, Set 3/4" x 15' aluminum rod
 1998 - Kapur and Associates established co-ordinates as part of Ozaukee County remonumentation program.

SEAL:



DATA SHOWN HEREON
 IS CERTIFIED AS CORRECT:

Mark Banton
 Ozaukee County Surveyor

DATE: 12/22/08

TIE SKETCH

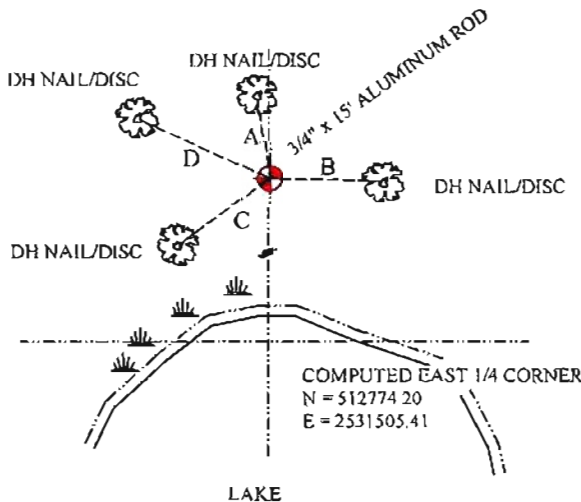

A = 5.39' @ 355°
 B = 10.15' @ 90°
 C = 14.21' @ 245°
 D = 15.79' @ 302°

MAINTENANCE RECORD

- MONUMENT LEGEND
- = BERNTSEN MONUMENT (SEE TYPE OF MON. ABOVE)
 - = CONCRETE MONUMENT w/ BRASS CAP
 - = CONCRETE MONUMENT w/ CROSS
 - = 5/8" REBAR WITH ALUMINUM CAP

DATE	BY WHOM	REMARKS
DEC 2008	M. BANTON	Redraw from tie sheet and re-number corner